



**TENNESSEE DEPARTMENT OF ENVIRONMENT AND CONSERVATION
DIVISION OF WATER RESOURCES
PERMIT FOR CONSTRUCTION OF SUBSURFACE SEWAGE DISPOSAL SYSTEM**

Issued to: Jason Williams Owner, Developer, Contractor, Installer, Etc. Location: 48 E Swann Ridge Road Hilham, TN 38568- County: Clay Map/Group: - Parcel: 0 Subdivision: Pointe at Dale Hollow Lot: 46A	Evaluation Based Upon: <input checked="" type="checkbox"/> 1. Soil Typing by Soil Scientist <input type="checkbox"/> a. General <input checked="" type="checkbox"/> b. High Intensity <input type="checkbox"/> c. Extra High Intensity <input type="checkbox"/> 2. Soil Percolation Test <input type="checkbox"/> 3. Environmental Specialist Estimated Absorption Rate: <u>30</u> MPI	Type of System: <input checked="" type="checkbox"/> 1. Conventional <input type="checkbox"/> 2. Modified Conventional <input checked="" type="checkbox"/> 3. Conventional System Substitute <input checked="" type="checkbox"/> Chamber <input checked="" type="checkbox"/> Expanded Polystyrene <input checked="" type="checkbox"/> Large Diameter Gravelless Pipe Gravel backfill in a 24" wide trench <u>no</u> required? <input type="checkbox"/> 4. Low Pressure Pipe <input type="checkbox"/> 5. Mound <input type="checkbox"/> 6. Lagoon <input type="checkbox"/> 7. Subsurface Drip System <input type="checkbox"/> 8. Other
Installation: <input checked="" type="checkbox"/> 1. New Installation <input type="checkbox"/> 2. Repair to Existing System <input type="checkbox"/> 3. System Modification	Approval Based Upon: State No. <u>T.C.A. 68-221-403</u> <input type="checkbox"/> (c) Percolation Test <input type="checkbox"/> (d) Grandfather clause - Current standards except those specified <input type="checkbox"/> (f) 12" (karst) and 6" (non-karst) buffer required <input type="checkbox"/> (i) 9" buffer required (24"-36" total soil depth) <input type="checkbox"/> (k) Grandfather clause - meets June 30, 1990 standards (repair only) <input checked="" type="checkbox"/> Current Standards <input type="checkbox"/> Other: _____	
Establishment: <input checked="" type="checkbox"/> 1. Residential: # Bedrooms <u>3</u> <input type="checkbox"/> 2. Other: _____ Gal/Day <u>0</u>		

This system shall consist of a two compartment septic tank holding 900 gallons, with 250 linear feet in 3-4 trenches, 36 inches wide and 24 (min) to 28 (max) inches deep. (Depth of gravel: _____ inches)

General Comments:

Also required:

- 1. Soil Improvement Practice (SIP)
 - Curtain Drain
 - Drawdown Drain
 - Interceptor Drain
- 2. Flow Diversion Valve
- 3. Sewage Pump
 - Pump Flow Rate (gpm) _____
 - TDH (ft) _____
- 4. Other: _____

All installers of subsurface sewage disposal systems must hold a valid annual license from the Tennessee Department of Environment and Conservation.

Please see attached drawing and supporting documentation.

The recipient of this permit agrees to construct or have constructed the above described system in accordance with T.C.A. 68-221-401 et. seq. and The Regulations To Govern Subsurface Sewage Disposal Systems. If any part of the system is covered before inspected and approved, it shall be uncovered by the recipient of the permit at the direction of personnel of the Department of Environment and Conservation. **Any cutting, filling or alterations of the soil conditions on the aforementioned property after this day may render this approval null and void.**

By Nicholas Harris Date 03/27/2024
(Date of issue)

This is a permit to construct and is not intended to imply approval of any work proposed or completed on this lot.

Tennessee Department of Environment and Conservation - Division of Water Resources
 Permit for Construction of a Subsurface Sewage Disposal System



Issued To: Jason Williams

Location: 48 E Swan Ridge Road
Hilham, TN 38568
Lot 46 A The Pointe

Inspector: Nicholas Harris

Date: March 27, 2024

General Notes:

- Please refer to the design specifications for the subsurface sewage disposal system on the first page of the construction permit.
- Contact the local Division of Water Resources representative to schedule a final inspection.
- All electric components (e.g., pump, alarm, etc.) for the subsurface sewage disposal system must be inspected and approved by the appropriate electrical inspector prior to requesting a final inspection. Documentation of the electrical inspection must be available during the final inspection.

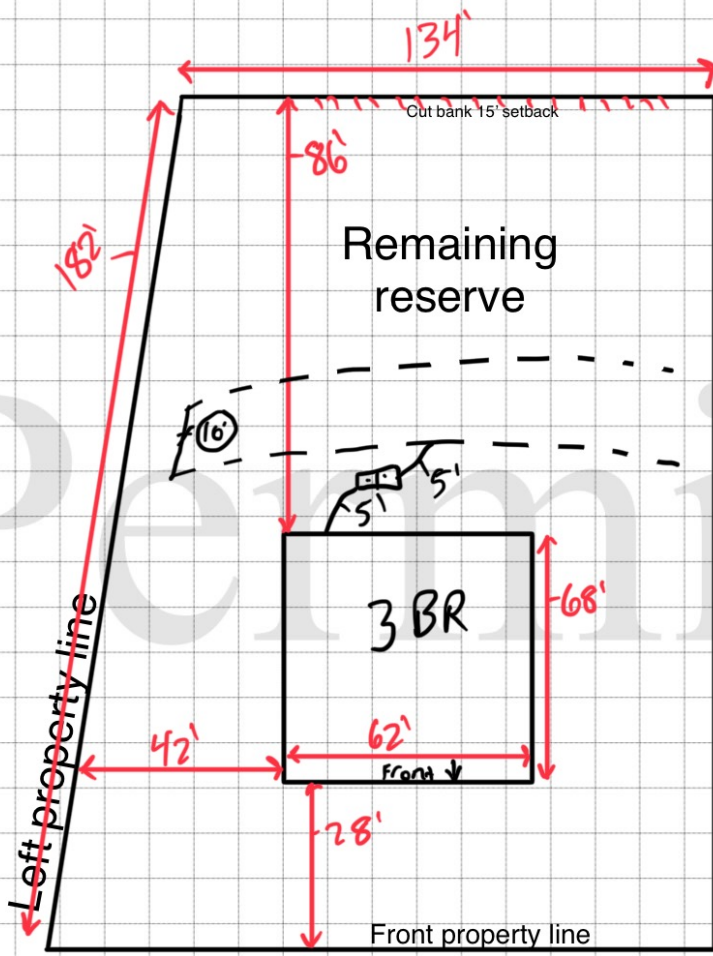

*All measurements and placements must be exactly as shown. Any altering or moving will void this permit.

E Swan Ridge