

Soils Map

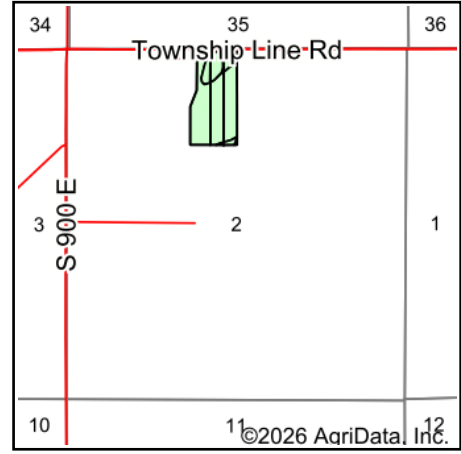

State: **Indiana**
 County: **Tiptecanoe**
 Location: **2-22N-3W**
 Township: **Sheffield**
 Acres: **22.69**
 Date: **4/17/2026**

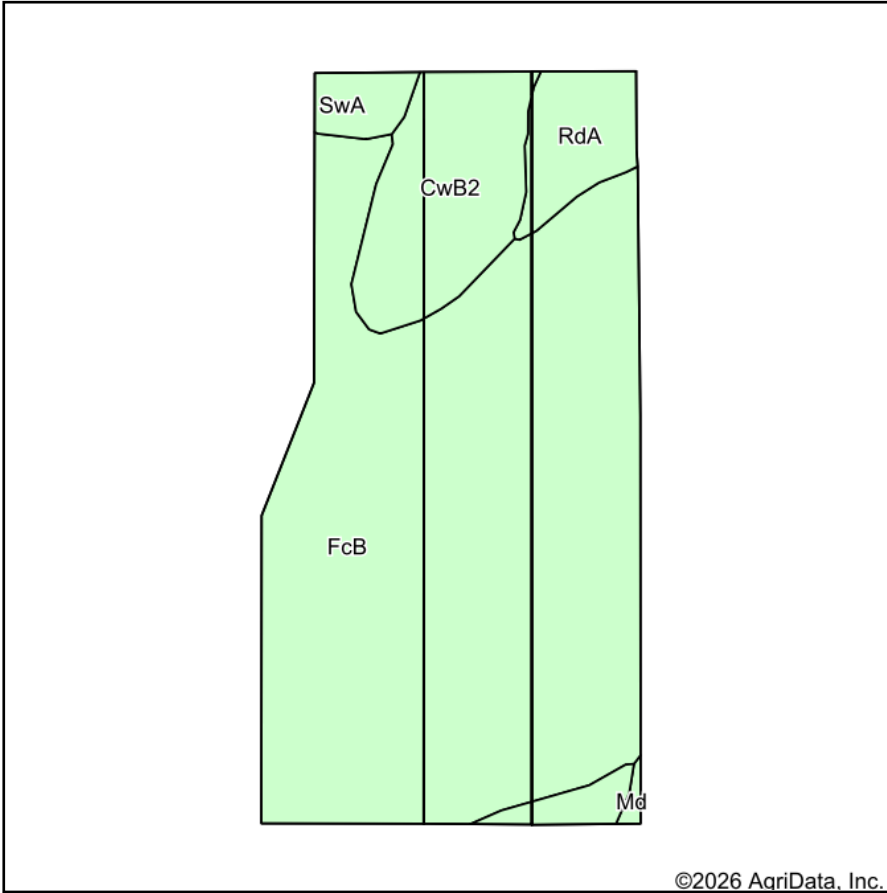

Maps Provided By:



Soils data provided by USDA and NRCS.

Area Symbol: IN157, Soil Area Version: 27

Code	Soil Description	Acres	Percent of field	Soil Drainage	Non-Irr Class *c	Corn Bu	Soybeans Bu	Winter wheat Bu
FcB	Fincastle-Crosby complex, 1 to 3 percent slopes	17.71	78.1%	Somewhat poorly drained	Ile	151	49	68
CwB2	Crosby-Miami silt loams, 2 to 4 percent slopes, eroded	2.83	12.5%	Somewhat poorly drained	Ile	138	46	62
RdA	Richardville silt loam, 0 to 2 percent slopes	1.19	5.2%	Well drained	I	145	51	73
SwA	Starks-Fincastle complex, 0 to 2 percent slopes	0.89	3.9%	Somewhat poorly drained	IIw	155	51	69
Md	Mahalasville-Treaty complex	0.07	0.3%	Poorly drained	IIw	185	53	74
Weighted Average					1.95	149.3	48.8	67.6

*c: Using Capabilities Class Dominant Condition Aggregation Method