

Country Living

2.75± Acres in Union County

1558 Hwy 30 New Albany, MS 38652



\$340,000



Expect More. Get More.

Property Information

Location:

- 1558 Hwy 30,
New Albany, MS 38652

Coordinates:

- 34.5421, -88.9109

Property Use:

- Residential

Property Highlights

- 2.75± acres in the Keownville Community
- 2,191± Sq Ft
- 7 Rooms
- 3 Bedrooms
- 2 Bathrooms
- 2 Car Attached Garage
- Wood Floors and Carpet
- Large Shed



Expect More. Get More.

**TOM
WISEMAN**
ASSOCIATE BROKER

Office: 662.268.6333

Cell: 662.317.0467

TWiseman@TomSmithLand.com

**A Real Estate Expert
You Can Trust!**



The Residence

2,191± Square Feet

Take a look at this 2,191± sqft. home with 2.75± acres and a large shed. The one-story brick home was constructed in 1979 and contains 7 rooms, 3 bedrooms, 2 bathrooms, a living room, a kitchen, a utility room, and is in excellent condition. It features wood floors in the living room, kitchen, and dining room, central heat/air, and gas logs. The metal building is suitable for storing your equipment or for use as a repair shop. It contains 5,288± sqft. Under roof with a 2,000± sqft enclosed area on a slab with a small office area and restroom. It also has a 20 x 24 garage area with the remaining 2,808± sqft being open storage, is in good condition, and has water and electric service. The property is located in the Keownville community, which is in the A-rated New Albany School District.



**TOM
WISEMAN**

ASSOCIATE BROKER

Office: 662.268.6333

Cell: 662.317.0467

TWiseman@TomSmithLand.com



Expect More. Get More.

The Residence



**TOM
WISEMAN**

ASSOCIATE BROKER

Office: 662.268.6333

Cell: 662.317.0467

TWiseman@TomSmithLand.com



Expect More. Get More.

Aerial Map

[VIEW INTERACTIVE MAP](#)



**TOM
WISEMAN**

ASSOCIATE BROKER

Office: 662.268.6333

Cell: 662.317.0467

TWiseman@TomSmithLand.com



Expect More. Get More.

Ownership Map

[VIEW INTERACTIVE MAP](#)

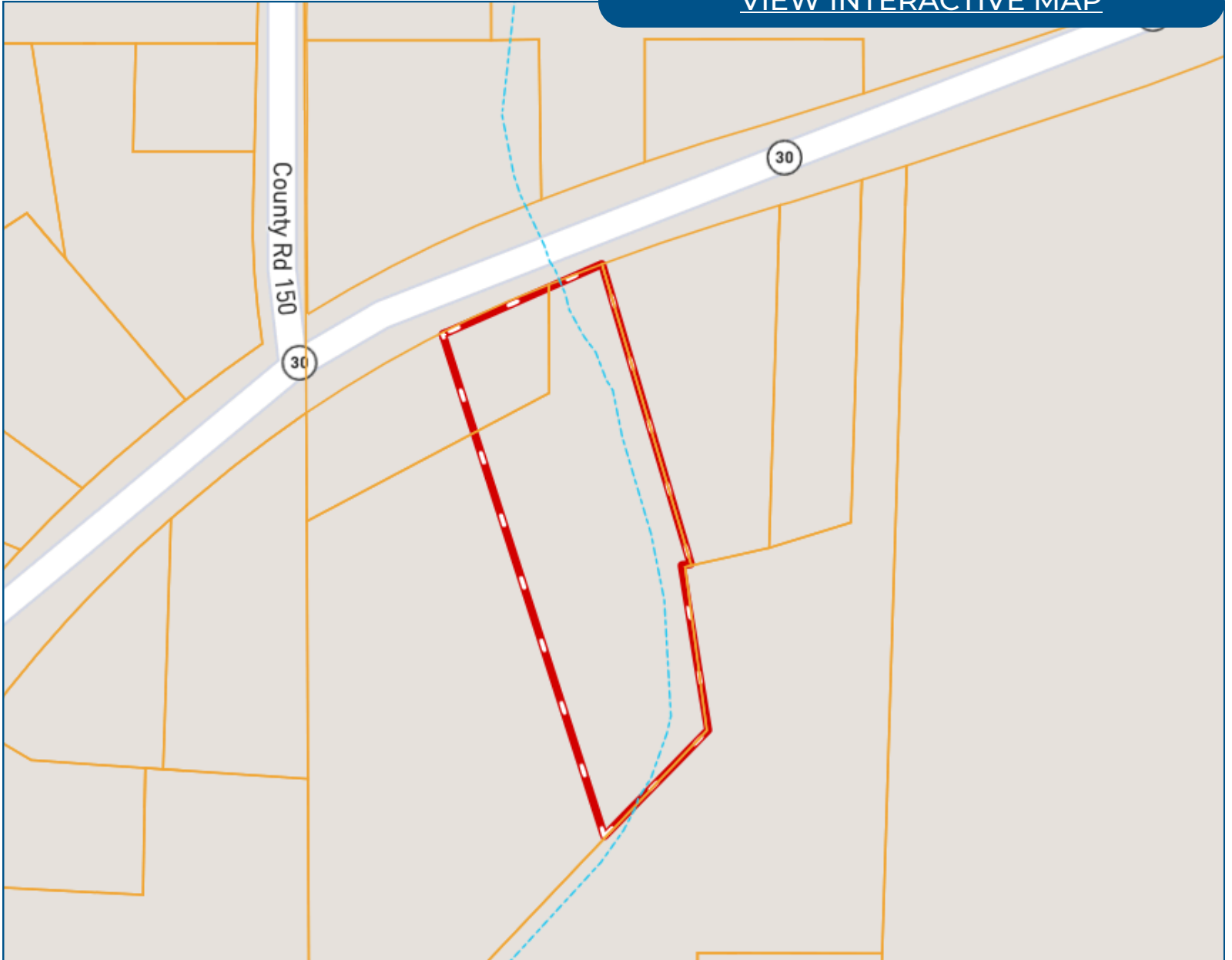

**TOM
WISEMAN**

ASSOCIATE BROKER

Office: 662.268.6333

Cell: 662.317.0467

TWiseman@TomSmithLand.com



Expect More. Get More.

Topo Map

[VIEW INTERACTIVE MAP](#)



**TOM
WISEMAN**

ASSOCIATE BROKER

Office: 662.268.6333

Cell: 662.317.0467

TWiseman@TomSmithLand.com



Expect More. Get More.

Directional Map

[VIEW INTERACTIVE MAP](#)

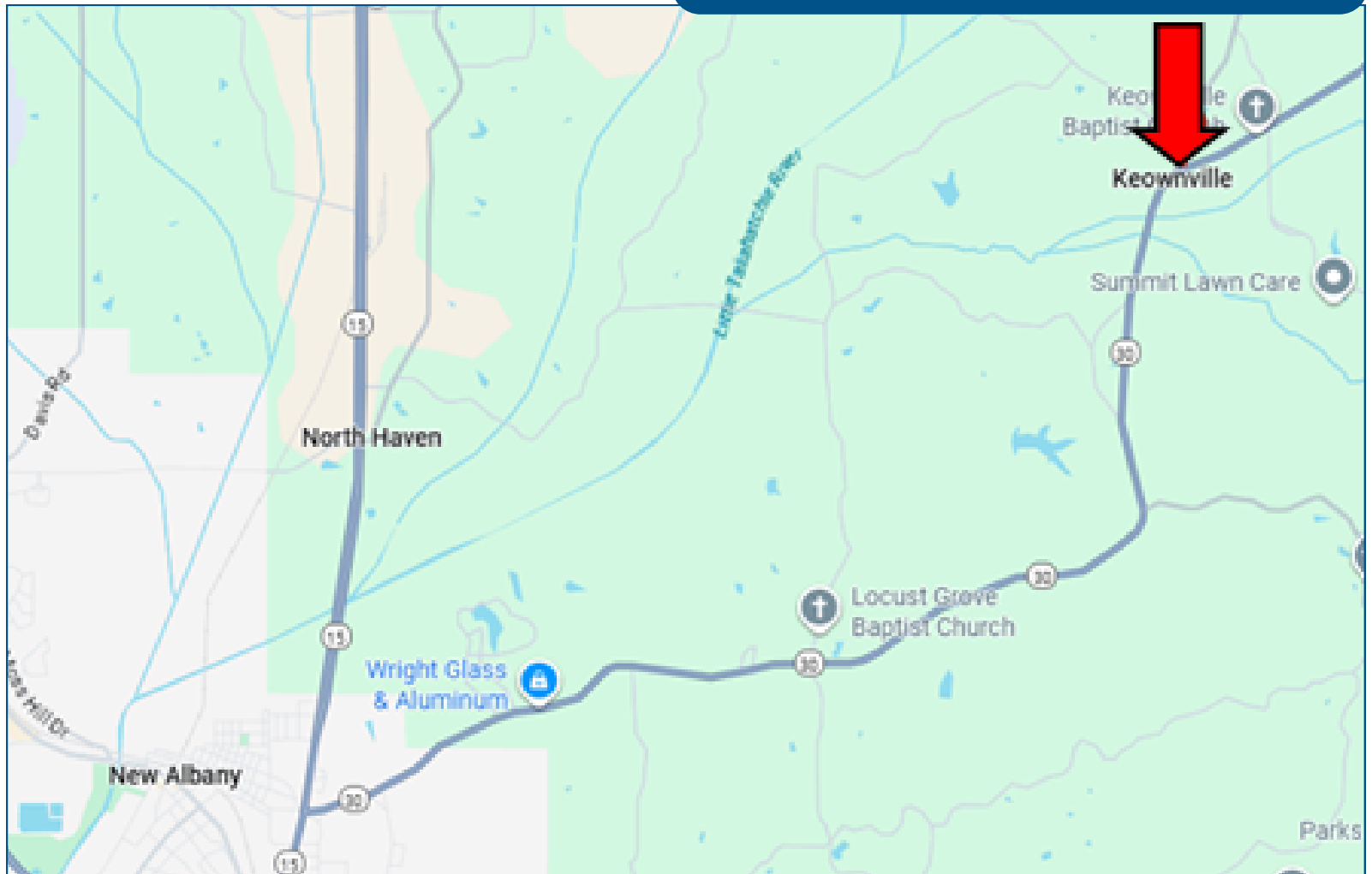

Directions from the Intersection of Hwy 15 and Hwy 30 in New Albany, MS: Travel Hwy 30 east for 7.1 miles, the property on the right.

**TOM
WISEMAN**

ASSOCIATE BROKER

Office: 662.268.6333

Cell: 662.317.0467

TWiseman@TomSmithLand.com



Expect More. Get More.

Listing Agent



TOM WISEMAN

ASSOCIATE BROKER

Certified Appraiser & Registered Forester

Tom has lived in New Albany all his life. He graduated from Mississippi State University in 1985 with a BS in Forestry and is a Registered Forester and Certified General Appraiser. He retired from the Right of Way Division of the Mississippi Department of Transportation in 2014 with 29 years as a staff appraiser, review appraiser, and forester.

Tom and his wife, Veronica, are active within The First Baptist Church New Albany. Tom is an avid outdoorsman and is involved with the Trail Life USA Troop MS-356. His outdoor activities also include hunting, fishing, bicycling, and golf. With a passion for the outdoors and being raised on the land, he is the perfect choice to assist you in finding the ideal place for your family's next home or tract of land.

OFFICE: 662.268.6333

CELL: 662.317.0467

TWISEMAN@TomSmithLand.com

**CALL TOM WISEMAN
TODAY!**

