

Home & Acreage For Sale



Hyannis Acreage

18.36 ± acres | Hyannis, Nebraska | Grant County

Nestled on a private access road on the southwest corner of Hyannis.

Spacious single-story home with modern updates, lots of storage, hardwood floors and privacy surrounded by colorful views!



Bonnie Downing, ARA

LISTING AGENT:

BONNIE DOWNING, ARA

C: 308.530.0083 | E: BDowning@AgriAffiliates.com

*Chase Dodson, Dallas Dodson, D.J. Lunkwitz, Faith Correll,
Mike Wilken, Mike Polk*



See more info & browse full gallery

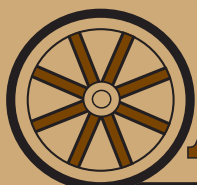

Offered exclusively by:

AGRI AFFILIATES®

Broken Bow, NE • AgriAffiliates.com • 308.872.1323

Information contained herein was obtained from sources deemed reliable. We have no reason to doubt the accuracy, but the information is not guaranteed. Prospective Buyers should verify all information. All maps provided by Agri Affiliates, Inc. are approximations only, to be used as a general guideline, and not intended as survey accurate. As with any agricultural land, this property may include noxious weeds. Agri Affiliates, Inc. and all agents are acting as Agent of the Seller.

Property Information

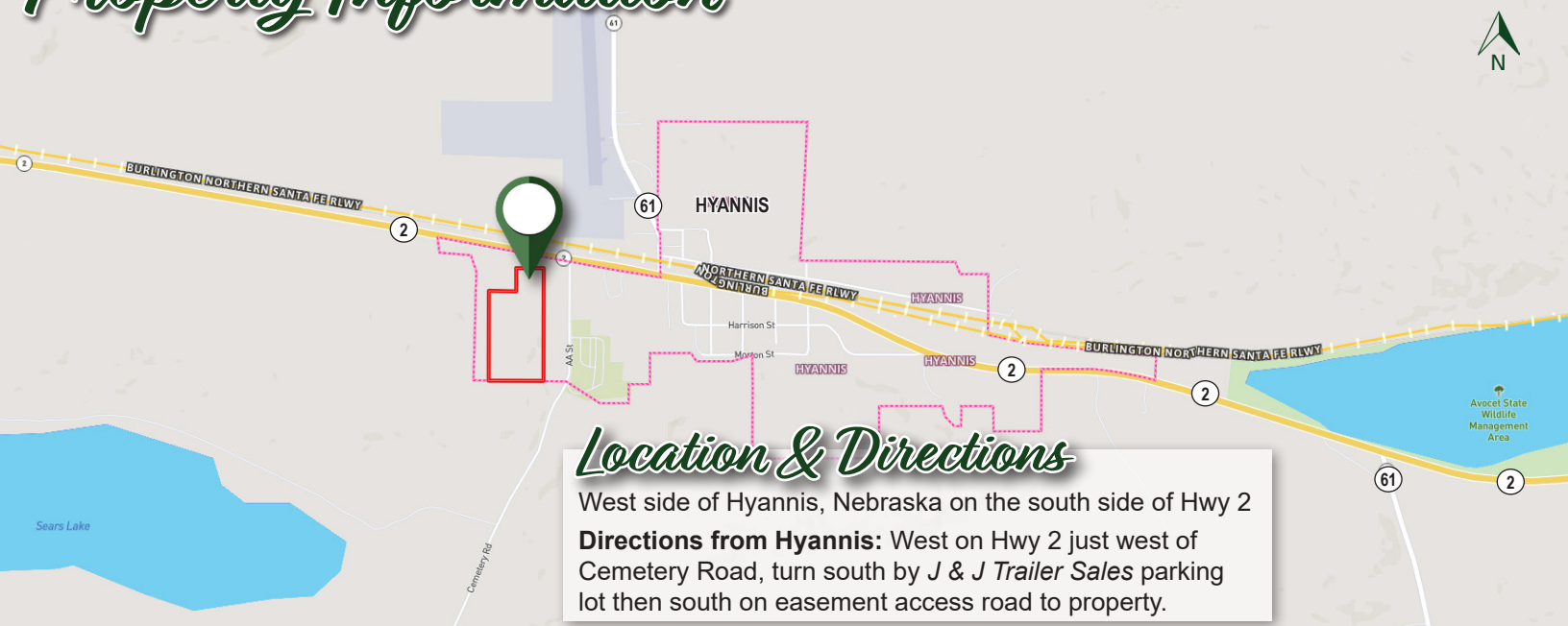

Location & Directions

West side of Hyannis, Nebraska on the south side of Hwy 2
Directions from Hyannis: West on Hwy 2 just west of Cemetery Road, turn south by *J & J Trailer Sales* parking lot then south on easement access road to property.

LEGAL DESCRIPTION:

Parts of Section 6, Township 23 North, Range 38 West of the 6th P.M. in Grant County, Nebraska, described as: All except north 205' in lots 9 & 10. All except north 440' lot 11 & north 485' lot 12 - Abbott's Addition to Hyannis (18.87A).

Property Address:

902 W Highway 2
 Hyannis, NE 69350

ACRES & TAXES:

18.36 ± tax-assessed acres
 2025 real estate taxes due in 2026: \$853.70

PRICE:

\$350,000



Kitchen/Dining



Main Bath



Porch



Bedroom

Home Details



Home Amenities

| | |
|----------------------|-----------------------------------|
| YEAR BUILT: | 1937 |
| LIVING SPACE: | 1,296 sq. ft. |
| BASEMENT: | 1,296 sq. ft., partially finished |
| BEDROOMS: | 2 |
| BATHROOM: | 1 |
| BONUS ROOMS: | 2 in basement |
| GARAGE: | Detached 440 sq. ft. 2-car garage |

- Appliances included (ask agent for details)
- Water softener - owned
- Central HVAC (installed 2000)
- Backup generator



Living Room

Showing by appointment only.



Basement Bonus Room



Bedroom



Basement Bonus Room

*Hyannis Acreage offers the space and seclusion
you've been looking for.*

With well-maintained outbuildings and quality fencing already in place, it's perfectly suited for an equestrian property or hobby operation.

All set against a backdrop of peaceful, scenic views that enhance the property's private, country feel.



Outbuildings

| | |
|-------------------------|---------------------------|
| TOOL SHED | 80 sq. ft. built in 1990 |
| TOOL SHED | 336 sq. ft. built in 1970 |
| DETACHED GARAGE: | 440 sq. ft. 2-car garage |

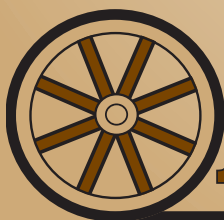

AGRI AFFILIATES®

Helping Clients Achieve Their Real Estate Goals

Broken Bow, NE • AgriAffiliates.com • 308.872.1323 • f @ X in ▶