

SKETCH ADDENDUM

Intended User
Property Address 220 High Point Lane
City Jasper County Marion State TN Zip Code 37347
Client

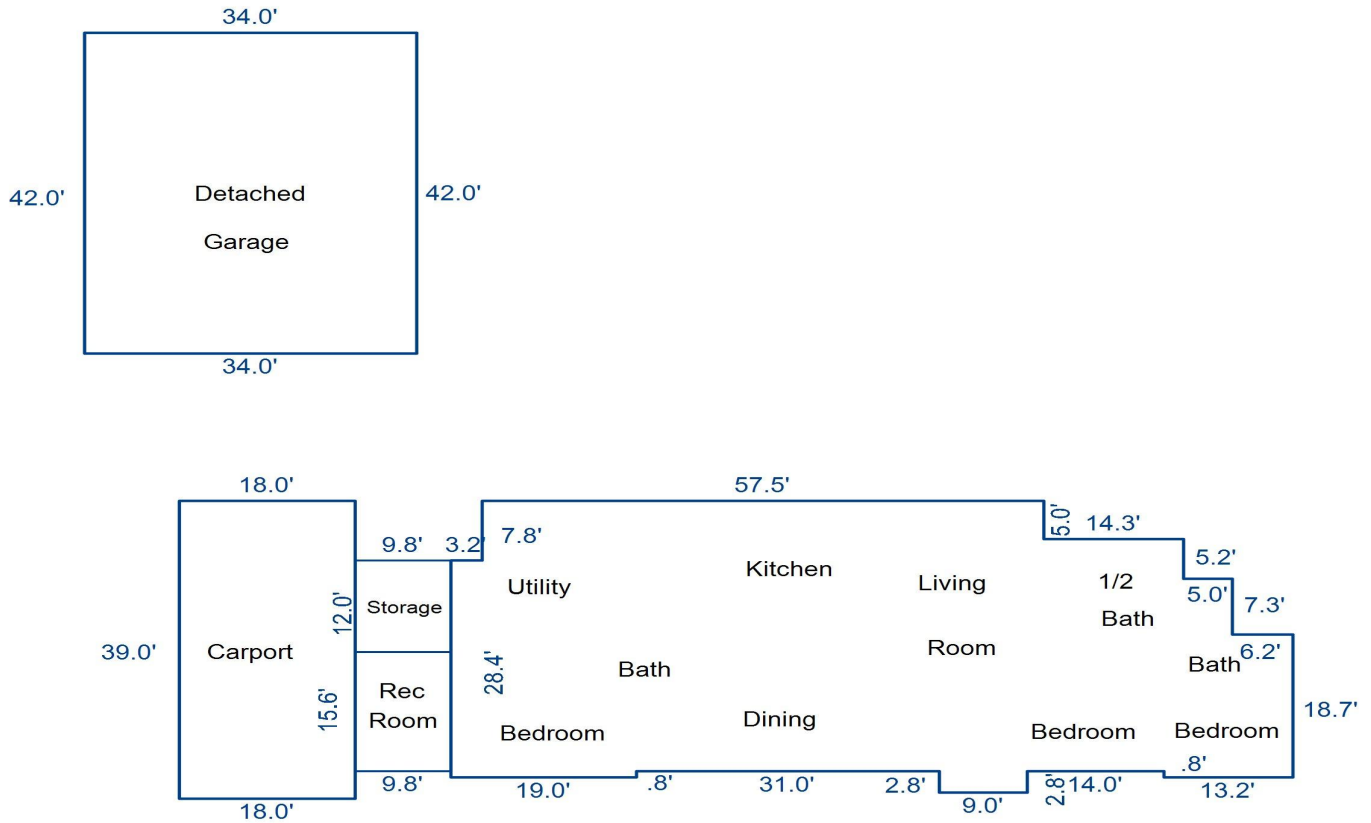

Sketch by Apex Sketch

AREA CALCULATIONS SUMMARY						AREA CALCULATIONS BREAKDOWN				
Code	Description	Factor	Net Size	Perimeter	Net Totals	Name	Base x	Height x	Width =	Area
GLA1	First Floor	1.0	2846.5	252.0	2846.5	First Floor	9.0 x	2.8 =		25.2
GAR	Carport	1.0	702.0	114.0			26.0 x	7.0 =		182.0
	Garage	1.0	1428.0	152.0	2130.0		18.7 x	6.2 =		115.9
OTH	Storage	1.0	117.6	43.6			5.2 x	2.0 =		10.4
	Rec Room	1.0	152.9	50.8	270.5		28.4 x	19.0 =		539.6
							15.8 x	7.8 =		123.2
							41.7 x	35.4 =		1476.2
							30.4 x	12.3 =		373.9
	Net LIVABLE			(rounded)	2,846	8 total items			(rounded)	2,846