

Charming Home With a Shop

Bolivar County

405 Preston Street, Benoit, MS 38725



\$135,000



**Tom
Smith
LAND AND
HOMES**

Expect More. Get More.

Property Information

Location:

- 27 Minutes to Cleveland, MS (22.6 Miles)

Property Use:

- Residential

Coordinates:

- 33.64785, -91.00535

Property Highlights

- 0.76± Acres
- 3 Bedrooms
- 2.5 Bathrooms
- 2,230± SqFt
- Built in 1930
- Attached Two-Car Carport
- Shop



ANTHONY STEEN REALTOR®, ALC®
O: 662.441.2500 | C: 662.645.5151
Anthony@TomSmithLand.com



ROB BALLINGER REALTOR®
O: 662.441.2500 | C: 662.941.7175
Rob@TomSmithLand.com

Expect More. Get More.

The Real Estate Experts You Can Trust!

601.898.2772 | TomSmithLandandHomes.com

Information is believed to be accurate but not guaranteed.



The Residence

2,230± SqFt

Charming home for sale at 405 Preston Street in Benoit, Bolivar County. This home features three bedrooms, two and a half bathrooms, and a sunroom, with a total of 2,230± square feet of heated and cooled living space. Situated on a 0.76± acre lot, the property includes an attached two-car carport. Additionally, there is a detached garage that can be used for vehicle storage, a workshop, or to store extra belongings. The spacious front and backyards offer a space for children and pets to play. Call Anthony Steen or Rob Ballinger today to schedule a tour of this charming home!



ANTHONY STEEN

REALTOR®, ALC®

O: 662.441.2500 | C: 662.645.5151

Anthony@TomSmithLand.com



ROB BALLINGER

REALTOR®

O: 662.441.2500 | C: 662.941.7175

Rob@TomSmithLand.com

Expect More. Get More.

The Real Estate Experts You Can Trust!

601.898.2772 | TomSmithLandandHomes.com

Information is believed to be accurate but not guaranteed.



The Residence



ANTHONY STEEN

REALTOR®, ALC®

O: 662.441.2500 | C: 662.645.5151

Anthony@TomSmithLand.com



ROB BALLINGER

REALTOR®

O: 662.441.2500 | C: 662.941.7175

Rob@TomSmithLand.com

Expect More. Get More.

The Real Estate Experts You Can Trust!

TomSmithLandandHomes.com

Information is believed to be accurate but not guaranteed.



The Residence



ANTHONY STEEN

REALTOR®, ALC®

O: 662.441.2500 | C: 662.645.5151

Anthony@TomSmithLand.com



ROB BALLINGER

REALTOR®

O: 662.441.2500 | C: 662.941.7175

Rob@TomSmithLand.com

Expect More. Get More.

TomSmithLandandHomes.com

The Real Estate Experts You Can Trust!

Information is believed to be accurate but not guaranteed.



The Residence



ANTHONY STEEN

REALTOR®, ALC®

O: 662.441.2500 | C: 662.645.5151

Anthony@TomSmithLand.com



ROB BALLINGER

REALTOR®

O: 662.441.2500 | C: 662.941.7175

Rob@TomSmithLand.com

Expect More. Get More.

The Real Estate Experts You Can Trust!

TomSmithLandandHomes.com

Information is believed to be accurate but not guaranteed.



Aerial Map

[VIEW INTERACTIVE MAP](#)



ANTHONY STEEN

REALTOR®, ALC®

O: 662.441.2500 | C: 662.645.5151

Anthony@TomSmithLand.com



ROB BALLINGER

REALTOR®

O: 662.441.2500 | C: 662.941.7175

Rob@TomSmithLand.com

Expect More. Get More.

TomSmithLandandHomes.com

The Real Estate Experts You Can Trust!

Information is believed to be accurate but not guaranteed.



Ownership Map

[VIEW INTERACTIVE MAP](#)

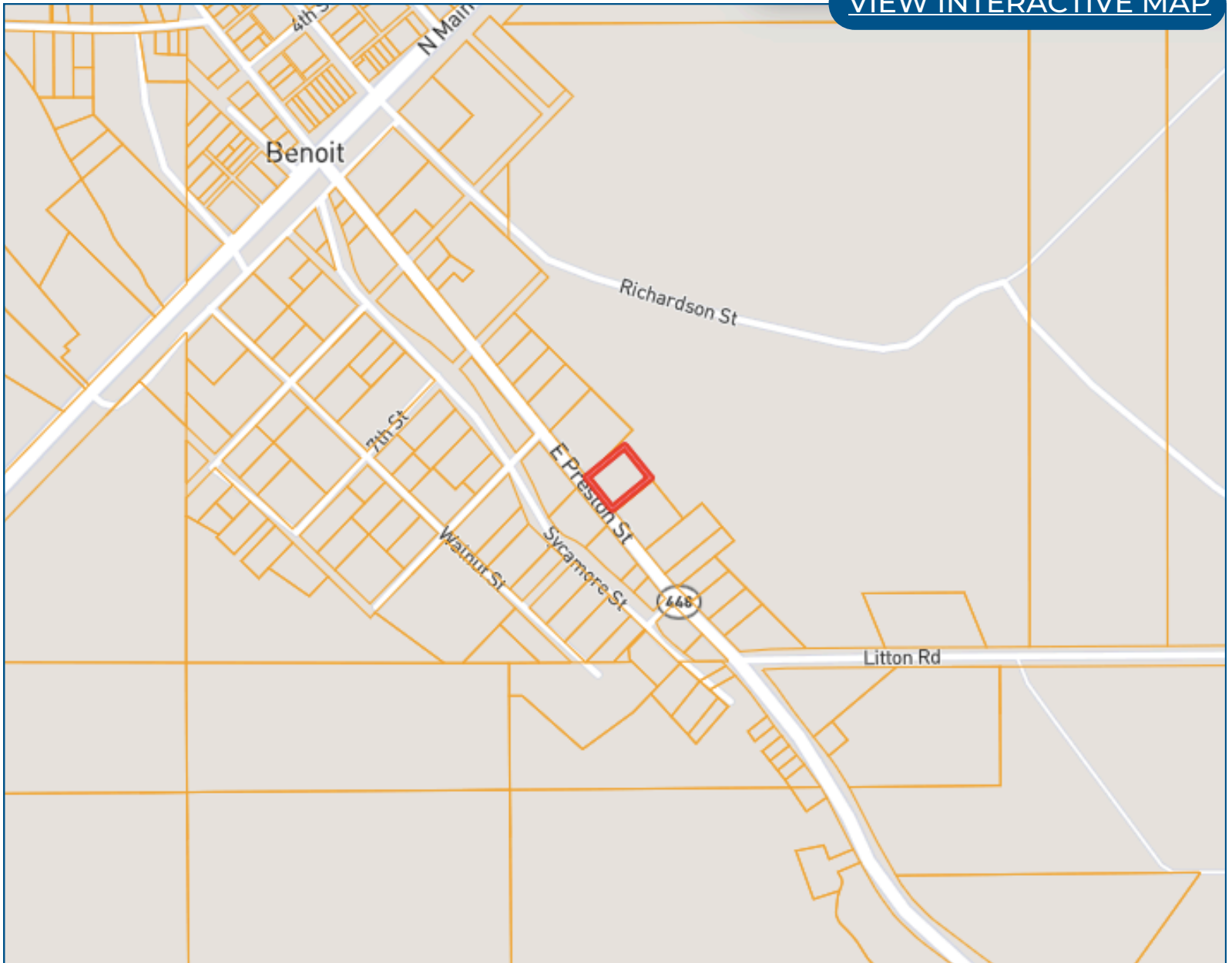

ANTHONY STEEN

REALTOR®, ALC®

O: 662.441.2500 | C: 662.645.5151

Anthony@TomSmithLand.com



ROB BALLINGER

REALTOR®

O: 662.441.2500 | C: 662.941.7175

Rob@TomSmithLand.com

Expect More. Get More.

The Real Estate Experts You Can Trust!

TomSmithLandandHomes.com

Information is believed to be accurate but not guaranteed.



Directional Map

[VIEW GOOGLE MAPS](#)

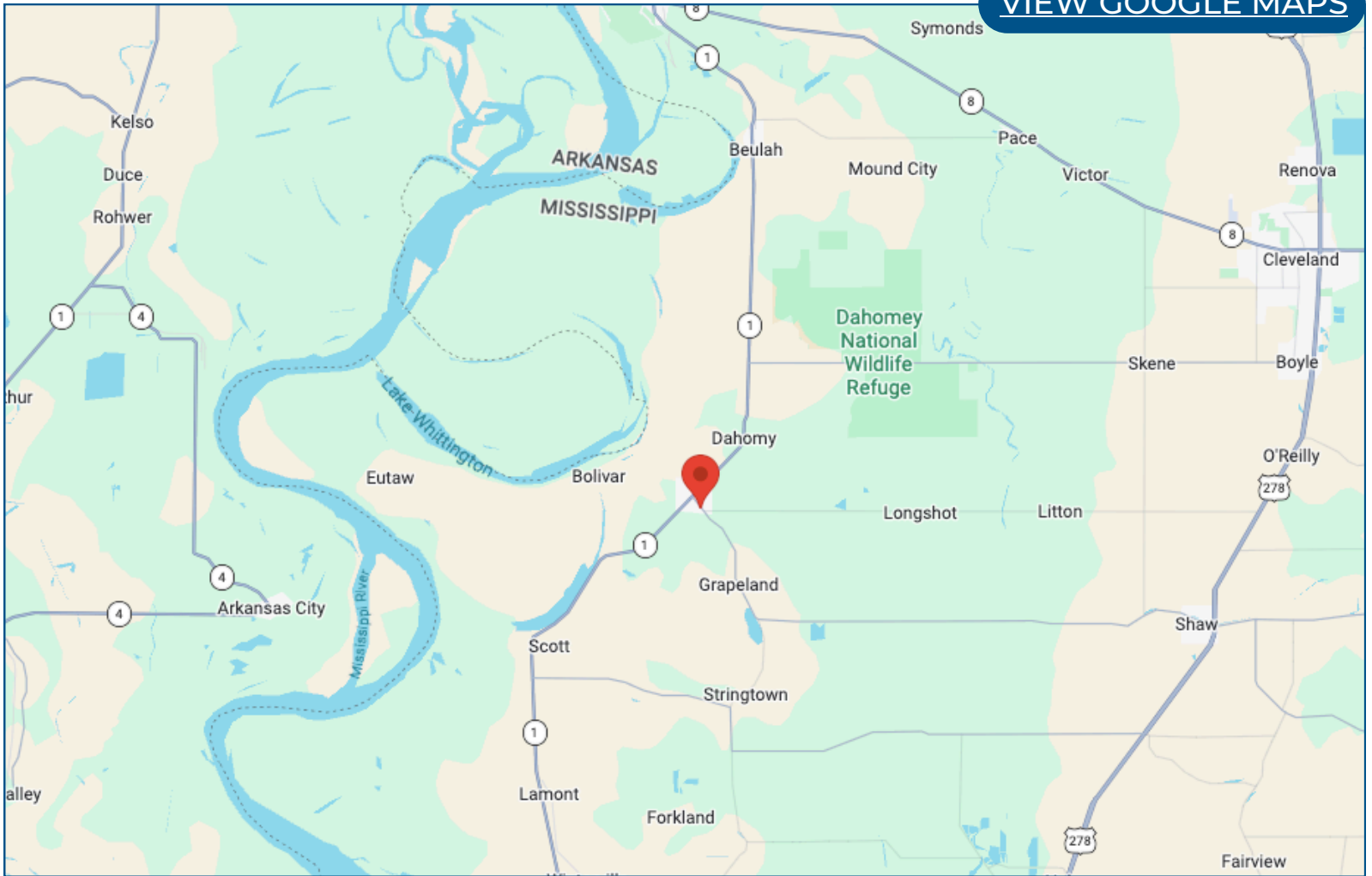

Directions from US-61 & MS-8, Cleveland, MS 38732

Travel south on US-61 S for 3.0 miles. Turn right onto MS-446 W for 15.2 miles. Turn left onto MS-1 S for 4.1 miles. Turn left onto Preston Street. After 0.3 miles, the home will be on the left.

ANTHONY STEEN

REALTOR®, ALC®

O: 662.441.2500 | C: 662.645.5151

Anthony@TomSmithLand.com



ROB BALLINGER

REALTOR®

O: 662.441.2500 | C: 662.941.7175

Rob@TomSmithLand.com

Expect More. Get More.

TomSmithLandandHomes.com

The Real Estate Experts You Can Trust!

Information is believed to be accurate but not guaranteed.

