

LEGAL DESCRIPTION
 STATE OF TEXAS
 COUNTY OF KAUFMAN

BEING all that certain tract or parcel of land in the John C. Hale Survey, A-202, Kaufman County, Texas, and being all that called 25.051 acre tract as conveyed from D.W. Myers, Jr., and Doris E. Myers to Jessie H. Lawson et ux, as recorded in Volume 1091, Page 169, of the Deed Records of Kaufman County, Texas, and being more particularly described as follows;

BEGINNING at a flat iron bar found for corner at the west corner of said tract, said point being in the northeast line of County Road No. 303;

THENCE N43°54'00"E, along the northwest line of said tract, a distance of 1925.04 feet to a 1/2" iron rod found for corner;

THENCE S45°25'33"E, a distance of 573.32 feet to a 1/2" iron rod set for corner;

THENCE S44°08'39"W, along the southeast line of said tract, a distance of 1910.94 feet to a 1/2" iron rod set for corner;

THENCE N44°38'54"W, along the northeast line of County Road No. 303, a distance of 43.00 feet to a 1/2" iron rod set for corner;

THENCE N47°01'43"W, continuing along the northeast line of said County Road No. 303, a distance of 522.22 feet to the POINT OF BEGINNING and containing 25.052 acres of land.

C:\05063

Surveyor's Certificate

I, Calvin S. Walker, Registered Professional Land Surveyor, do hereby certify, that the plat shown hereon accurately represents the property as determined by an on the ground survey made under my direction and supervision and that all corners are as shown hereon.

There are no visible encroachments, conflicts or protrusions apparent on the ground, except as shown.

Kalvin S. Walker R.P.L.S. No. 4962
 Date 6/9/05 Project No. 05063

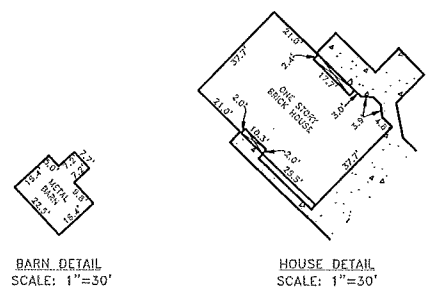

BOUNDARY SURVEY						
25.052 ACRES IN THE JOHN C. HALE SURVEY, A-202						
V	VANNON SURVEYORS, INC.					S
P.O. BOX 249 ~ 306 N. ADELAIDE ST. TERRELL, TEXAS 75160 ~ PH 972-563-7101						
KAUFMAN COUNTY, TEXAS						
DESIGN	DRAWN	DATE	SCALE	NOTES	FILE	NO.
KSW	EC	6/9/05	1"=100'		05063	1/1