

Soils Map

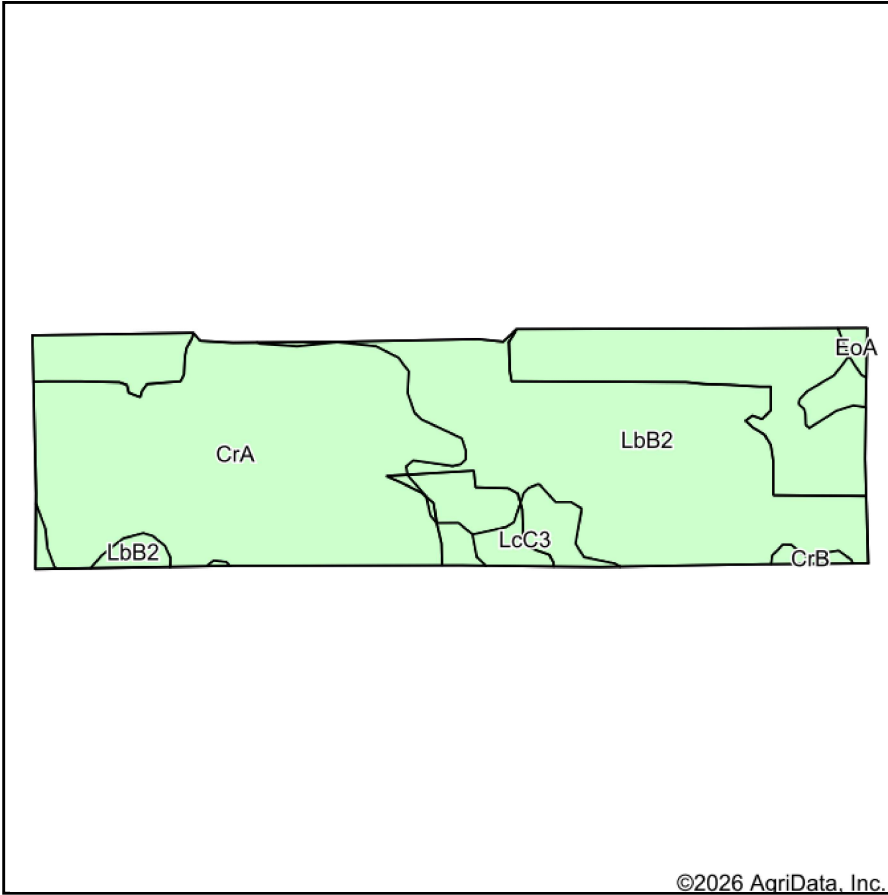

Soils data provided by USDA and NRCS.

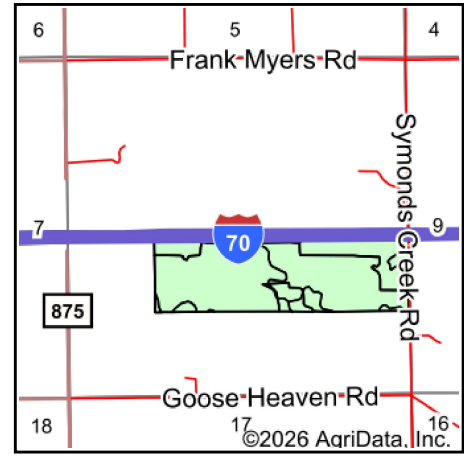

State: **Indiana**
 County: **Wayne**
 Location: **8-16N-12E**
 Township: **Jackson**
 Acres: **100.01**
 Date: **1/15/2026**



Maps Provided By:



© AgriData, Inc. 2025

www.AgriDataInc.com



Area Symbol: IN177, Soil Area Version: 28

Code	Soil Description	Acres	Percent of field	Non-Irr Class *c	Corn Bu	Soybeans Bu
LbB2	Losantville silt loam, 2 to 6 percent slopes, eroded	49.17	49.1%	Ile	121	43
CrA	Crosby silt loam, Southern Ohio Till Plain, 0 to 2 percent slopes	45.46	45.5%	IIw	123	41
LcC3	Losantville clay loam, 6 to 12 percent slopes, severely eroded	4.42	4.4%	IVe	111	38
CrB	Crosby-Celina silt loams, 2 to 4 percent slopes, eroded	0.50	0.5%	IIw	138	46
EoA	Eldean loam, 0 to 2 percent slopes	0.46	0.5%	IIs	115	37
Weighted Average				2.09	121.5	41.9

*c: Using Capabilities Class Dominant Condition Aggregation Method