

**NEW-CONSTRUCTION HOME ON 2.5± ACRES**

**112 STEVENSON ROAD**

**JONES COUNTY, MS**

**\$308,000**



**SMALLTOWN**

**HUNTING PROPERTIES  
& REAL ESTATE<sup>SM</sup>**

**OFFICE (769) 760-0005 | [WWW.SMALLTOWNPROPERTIES.COM](http://WWW.SMALLTOWNPROPERTIES.COM)**

# 112 STEVENSON ROAD

## PROPERTY PROFILE

### LOCATION:

- 112 Stevenson Road  
Laurel, MS 39443
- Sharon Community
- Jones County
- 5.6± Miles NE of  
Downtown Laurel
- 17.6± Miles NE of Jones College
- 40± Miles NE of Hattiesburg

### COORDINATES:

- 31.766031, -89.108853

### PROPERTY USE:

- Residential

### PROPERTY INFORMATION:

- 2.5± Acres
- 2,221± SqFt New Home
  - 1,516± SqFt Heated & Cooled
  - 4 Bedrooms/2 Bathrooms
  - Modern Finishes
  - 2-Car Garage
- Gently Rolling Terrain
- West Jones School District
- Jones County Community College

### TAX INFORMATION:

- Parcel ID: 163T-09-00-032.00



**SMALLTOWN**  
HUNTING PROPERTIES  
& REAL ESTATE<sup>SM</sup>

**DEWAYNE ATKINSON**

LAND SPECIALIST

C: 601-832-3075

O: 769-760-0005

dewayne@smalltownproperties.com

2121 5th St., Ste 206 - Meridian, MS 39301

smalltownproperties.com

Information is believed to be accurate but not guaranteed.

# WELCOME TO 112 STEVENSON ROAD

WELCOME TO 112 STEVENSON ROAD, A NEW-CONSTRUCTION HOME IN THE QUIET SHARON COMMUNITY OF JONES COUNTY, MISSISSIPPI, THAT BRINGS TOGETHER MODERN DESIGN, PRACTICAL SPACE, AND A PEACEFUL SETTING.

. Sitting on 2.5± acres, the house will offer roughly 1,516 square feet of heated and cooled living space with four bedrooms, two bathrooms, and a two-car garage, totaling about 2,221 square feet under roof. It's being built right now, giving future owners the chance to enjoy a brand-new home in a rural setting without giving up convenience.

Sharon sits just north of Laurel and is part of the Laurel micropolitan area, giving the benefit of small-community living with quick access to the largest city in Jones County. Laurel is only about six miles away, offering restaurants, shopping, medical facilities, and the well-known historic downtown district that continues to grow in popularity. Sharon itself is known for its quiet pace, open land, and low-density living, making it a great fit for anyone wanting space and privacy without being far from town. The area is also within the West Jones School District and close to Jones College, adding value for families and long-term homeowners.



**SMALLTOWN**  
HUNTING PROPERTIES  
& REAL ESTATE<sup>SM</sup>

**DEWAYNE ATKINSON**

LAND SPECIALIST

C: 601-832-3075

O: 769-760-0005

dewayne@smalltownproperties.com

2121 5th St., Ste 206 - Meridian, MS 39301

smalltownproperties.com

Information is believed to be accurate but not guaranteed.

# MORE ABOUT 112 STEVENSON ROAD

The surrounding part of Jones County is made up of gently rolling terrain, family land, and well-kept rural communities. Residents enjoy a slower pace, low cost of living, and easy access to outdoor recreation. Laurel's amenities, combined with the peaceful setting of Sharon, create a strong balance for buyers who want quiet living with the convenience of a larger town just minutes away. With new construction underway, this home will offer the comfort of modern finishes in a location that continues to attract people looking for space, privacy, and the feel of true country living.

Contact Dewayne Atkinson today to schedule a private showing and make 112 Stevenson Road your new address.

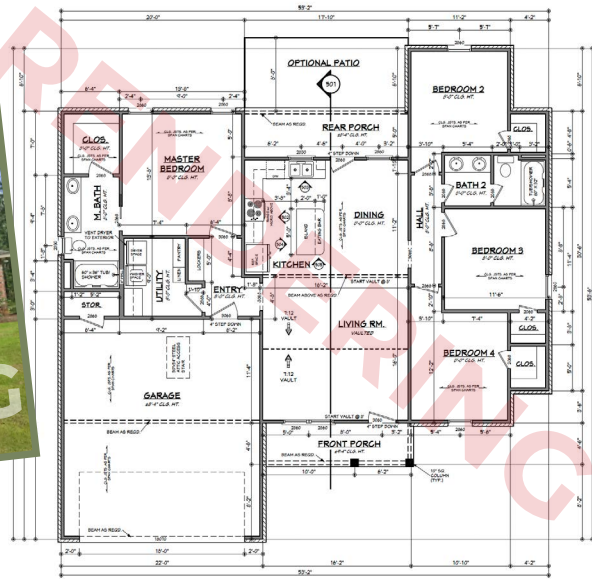

NOTE: CONTRACTOR TO LOCATE HVAC AND PEX UNITS AT SITE.

## FLOOR PLAN



**SMALLTOWN**  
HUNTING PROPERTIES  
& REAL ESTATE<sup>SM</sup>

**DEWAYNE ATKINSON**  
LAND SPECIALIST

C: 601-832-3075

O: 769-760-0005

dewayne@smalltownproperties.com

2121 5th St., Ste 206 - Meridian, MS 39301

smalltownproperties.com

*Information is believed to be accurate but not guaranteed.*

land id. LINK

SOUTH RD

STEVENSON RD



Directions From Laurel, MS: Travel on MS-537 N/Sharon Road for 4.9 miles. Turn right onto Stevenson Road, and in 0.6 miles, the property will be on the right, across from #107. Look for orange flags marking the driveway and homesite.

[LINK TO GOOGLE MAP DIRECTIONS](#)



**SMALLTOWN**  
HUNTING PROPERTIES  
& REAL ESTATE<sup>SM</sup>

**DEWAYNE ATKINSON**

LAND SPECIALIST

C: 601-832-3075

O: 769-760-0005

dewayne@smalltownproperties.com

2121 5th St., Ste 206 - Meridian, MS 39301

smalltownproperties.com

Information is believed to be accurate but not guaranteed.