

Soils Map

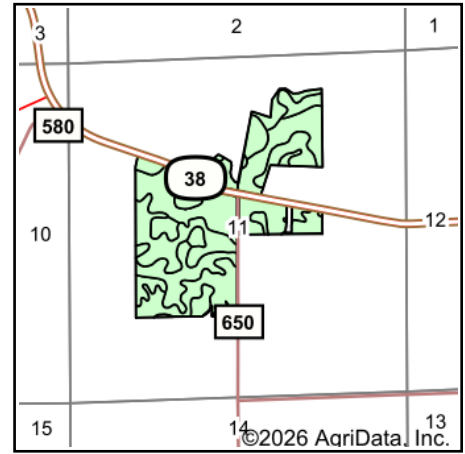

State: **Indiana**
 County: **Clinton**
 Location: **11-20N-1E**
 Township: **Kirklin**
 Acres: **127.19**
 Date: **5/6/2026**

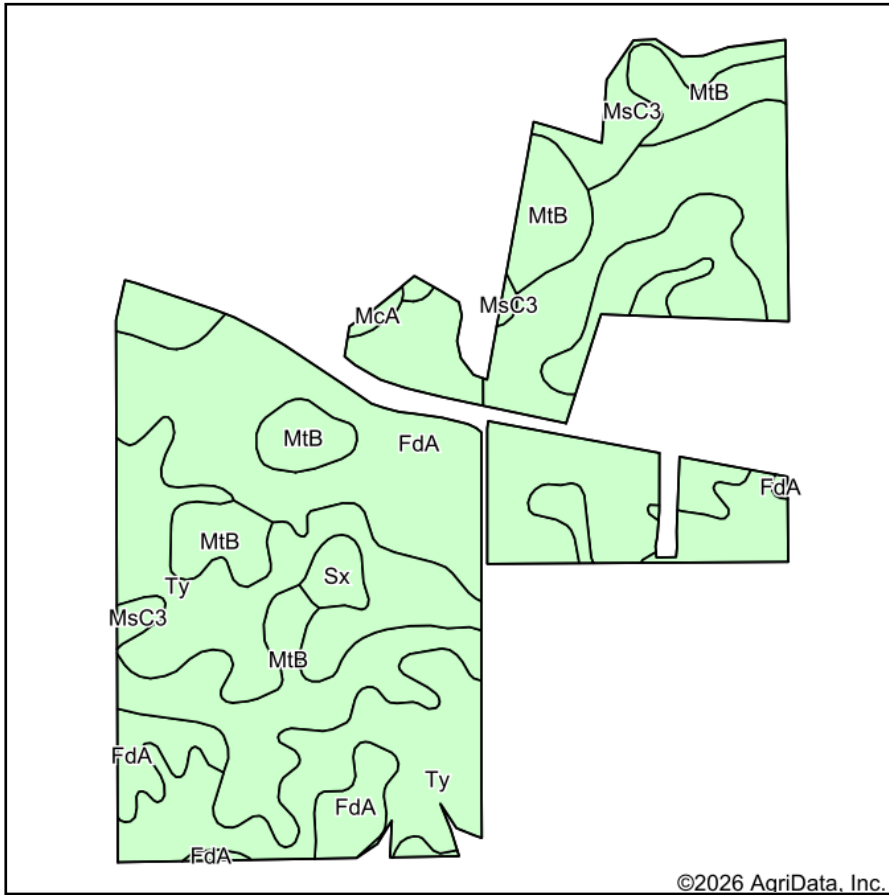

Maps Provided By:



Soils data provided by USDA and NRCS.

©2026 AgriData, Inc.

© AgriData, Inc. 2025

www.AgriDataInc.com

Area Symbol: IN023, Soil Area Version: 29

Code	Soil Description	Acres	Percent of field	Soil Drainage	Non-Irr Class *c	Corn Bu	Soybeans Bu	Winter wheat Bu
FdA	Fincastle-Crosby silt loams, 0 to 2 percent slopes	53.54	42.1%	Somewhat poorly drained	IIw	156	51	69
Ty	Treaty silt loam, 0 to 2 percent slopes	40.69	32.0%	Poorly drained	IIw	177	62	61
MtB	Miami-Crosby silt loams, 2 to 6 percent slopes	26.14	20.6%	Moderately well drained	IIe	147	50	65
MsC3	Miami clay loam, 6 to 12 percent slopes, severely eroded	4.87	3.8%	Moderately well drained	IVe	126	44	56
Sx	Starks silt loam, 0 to 2 percent slopes	1.54	1.2%	Somewhat poorly drained	IIw	164	53	66
McA	Martinsville silt loam, 0 to 2 percent slopes	0.41	0.3%	Well drained	I	145	51	73
Weighted Average					2.07	159.8	54.1	65.1

*c: Using Capabilities Class Dominant Condition Aggregation Method

Soils data provided by USDA and NRCS.