

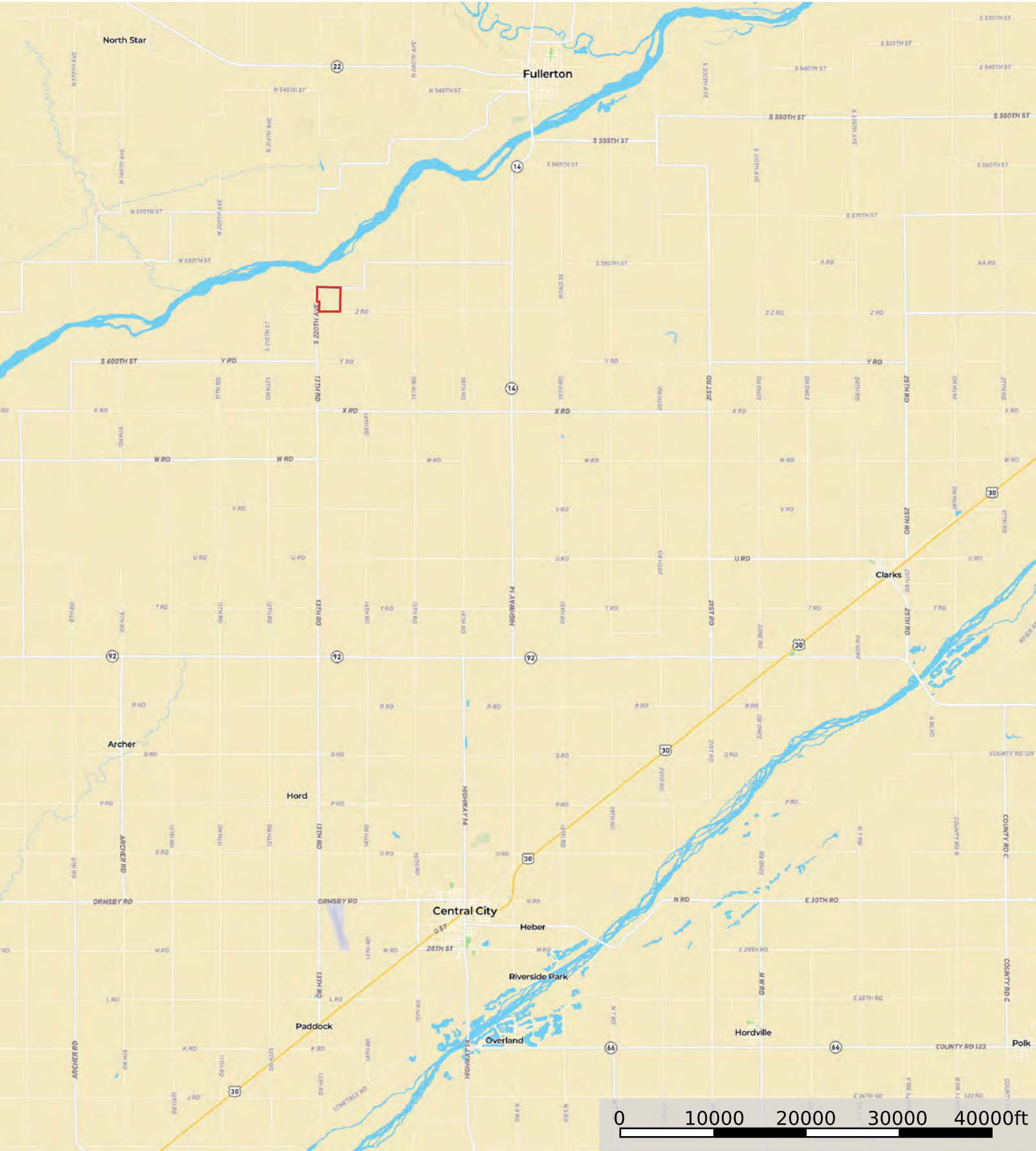

Boundary



 Boundary



Boundary

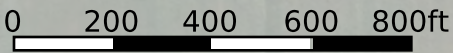

Boundary

Boundary 144.11 ac

SOIL CODE	SOIL DESCRIPTION	ACRES	%	CPI	NCCPI	CAP
8470	Gibbon silt loam, 0 to 2 percent slopes, occasionally flooded	50.53	35.07	0	78	2w
8878	Hord very fine sandy loam, 0 to 1 percent slopes	39.82	27.63	0	67	1
6843	Ortello fine sandy loam, 1 to 3 percent slopes	33.27	23.09	0	54	2e
6846	Ortello fine sandy loam, 3 to 6 percent slopes, eroded	7.04	4.89	0	48	3e
8865	Hord fine sandy loam, 0 to 1 percent slopes	5.58	3.87	0	67	2e
3726	Detroit silt loam, 0 to 1 percent slopes	4.86	3.37	0	62	2c
6816	Loretto-Thurman complex, 3 to 6 percent slopes	1.66	1.15	0	60	3e
3521	Cass fine sandy loam, 0 to 2 percent slopes, occasionally flooded	1.35	0.94	0	52	2w
TOTALS		144.1 1(*)	100%	-	66.54	1.78

(*) Total acres may differ in the second decimal compared to the sum of each acreage soil. This is due to a round error because we only show the acres of each soil with two decimal.

Capability Legend

Increased Limitations and Hazards

Decreased Adaptability and Freedom of Choice Users

Land, Capability

	1	2	3	4	5	6	7	8
'Wild Life'	•	•	•	•	•	•	•	•
Forestry	•	•	•	•	•	•	•	
Limited	•	•	•	•	•	•	•	
Moderate	•	•	•	•	•	•		
Intense	•	•	•	•	•			
Limited	•	•	•	•				
Moderate	•	•	•					
Intense	•	•						
Very Intense	•							

Grazing Cultivation

(c) climatic limitations (e) susceptibility to erosion

(s) soil limitations within the rooting zone (w) excess of water

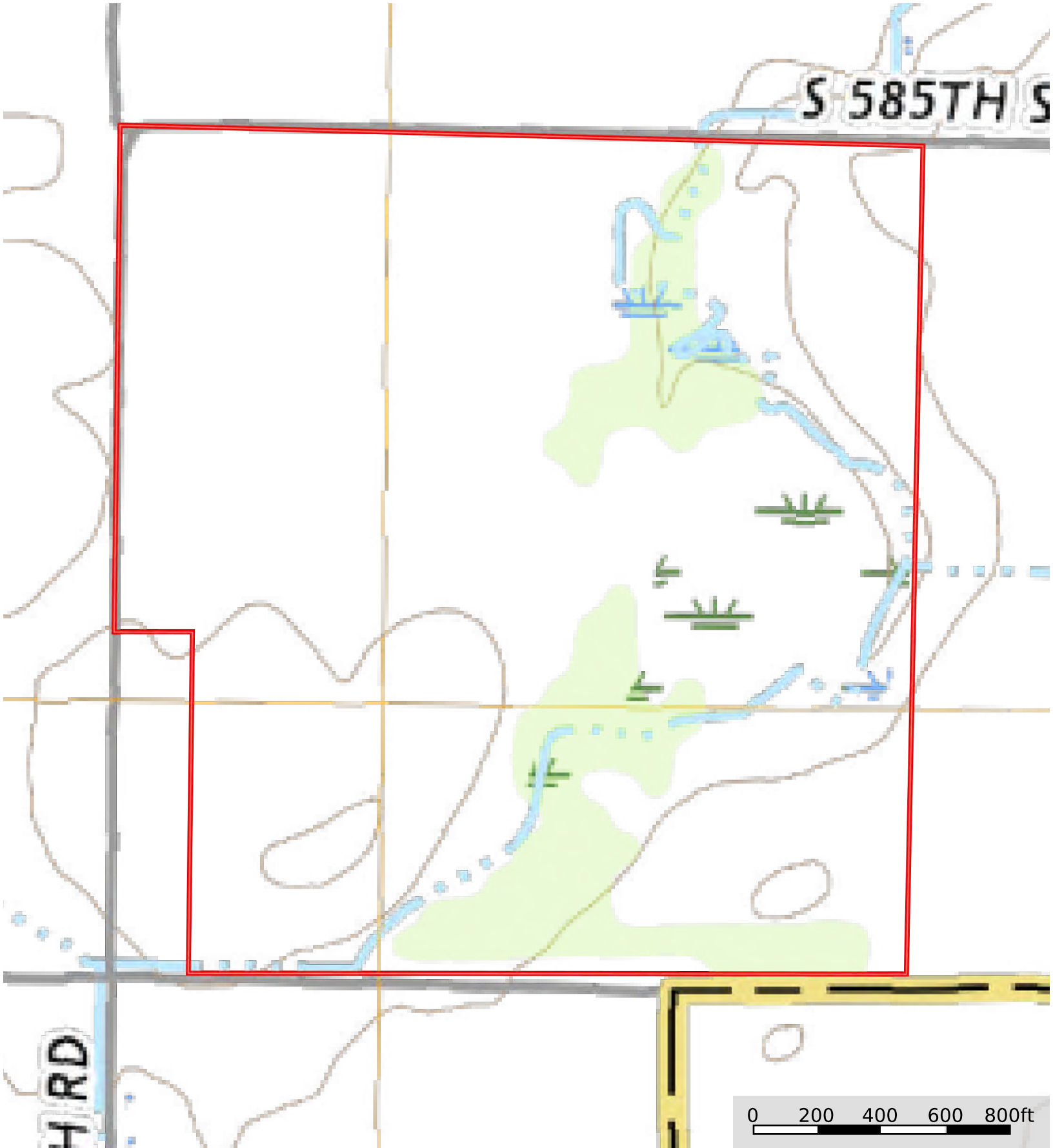

 Boundary

