

LAND FOR SALE

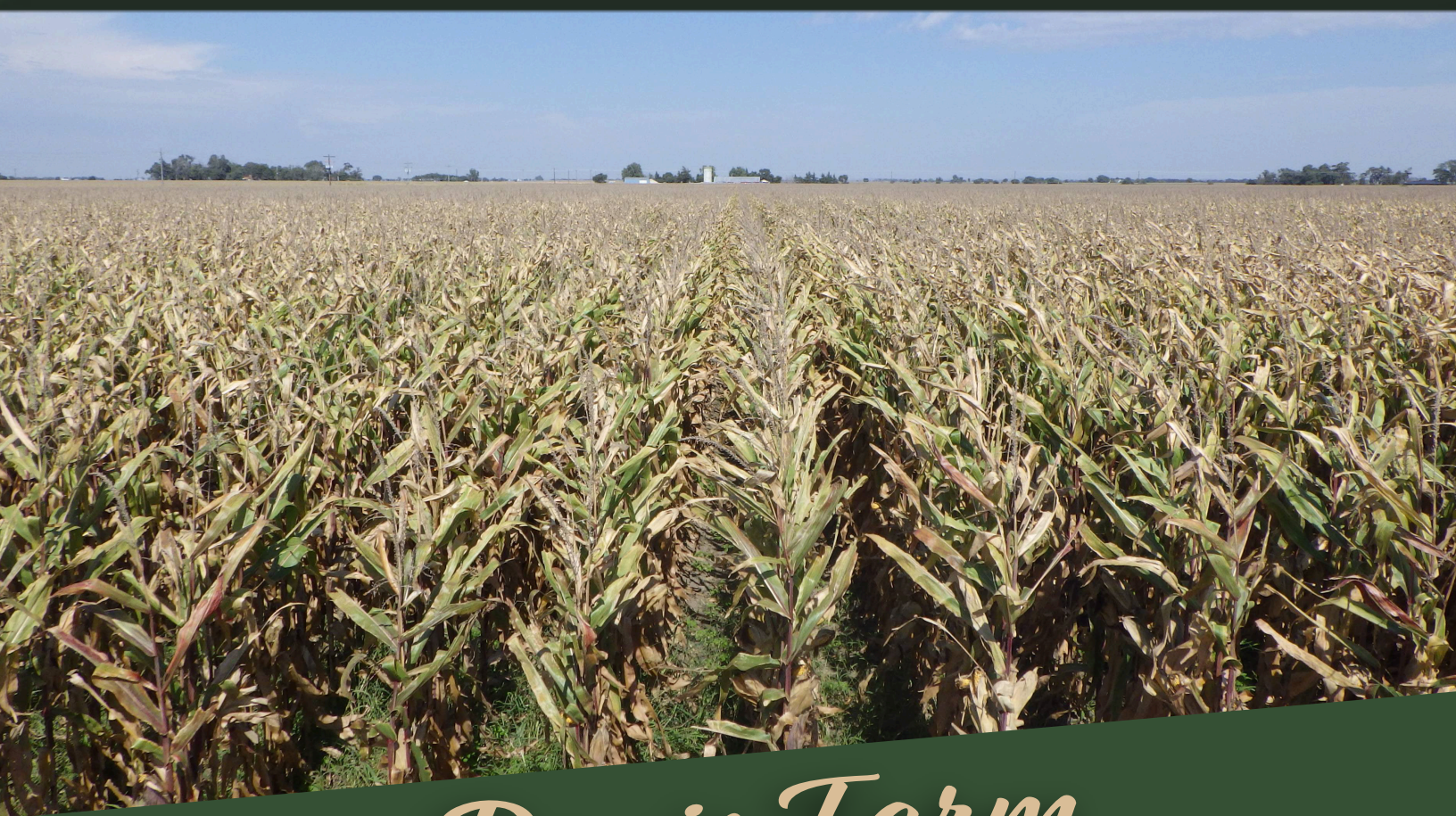

Davis Farm DAWSON COUNTY, NEBRASKA



*76.04 acres located two miles
southwest of Lexington, Nebraska*



LISTING AGENT: **C: 308.233.4605**
Bart Woodward **E: Bart@AgriAffiliates.com**

Salespeople: Bryan Danburg, Mike Wilken, Kent Richter,
Bruce Dodson, Chase Dodson, Bonnie Downing, Adam Pavelka,
Dan Muirhead, Faith Correll, Brad Atkins, D.J. Lunkwitz

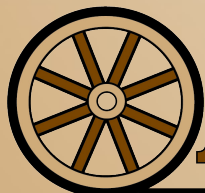

Offered exclusively by

AGRI AFFILIATES®

Kearney, NE • AgriAffiliates.com • 308.234.4969

Information contained herein was obtained from sources deemed reliable. We have no reason to doubt the accuracy, but the information is not guaranteed. Prospective Buyers should verify all information. All maps provided by Agri Affiliates, Inc. are approximations only, to be used as a general guideline, and not intended as survey accurate. As with any agricultural land, this property may include noxious weeds. Agri Affiliates, Inc. and all agents are acting as Agent of the Seller.

Property Maps

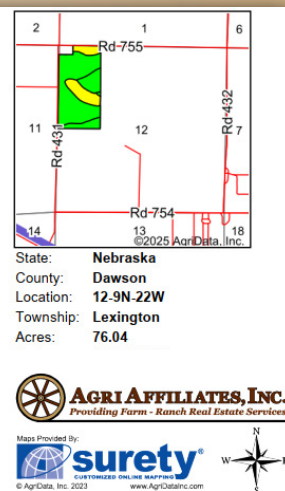

Soils data provided by USDA and NRCS.

Area Symbol: NE047, Soil Area Version: 23

Code	Soil Description	Acres	Percent of field	Non-Irr Class Legend	Non-Irr Class °c	Irr Class °c	SRPG	Alfalfa hay Tons	Alfalfa hay Irrigated Tons	Corn Bu	Corn Irrigated Bu	Winter wheat Bu	*n NCCPI Corn	*n NCCPI Soybeans
8831	Gosper loam, 0 to 1 percent slopes	46.43	61.1%		IIc	I	59	3	6	52	154	35	36	58
8832	Gosper loam, saline-alkali, 0 to 1 percent slopes	15.45	20.3%		IVs	III	40	2	4	39	109	23	3	28
8553	Silver Creek silt loam, rarely flooded	8.09	10.6%		IIIw	IIw	51	3	5	52	138	35	28	51
8815	Cozad silt loam, 0 to 1 percent slopes	6.07	8.0%		IIc	I	67						57	69
Weighted Average					2.51	1.62	54.9	2.6	5	45.2	130.9	29.8	*n 30.1	*n 52

*n: The aggregation method is "Weighted Average using all components"
 °c: Using Capabilities Class Dominant Condition Aggregation Method

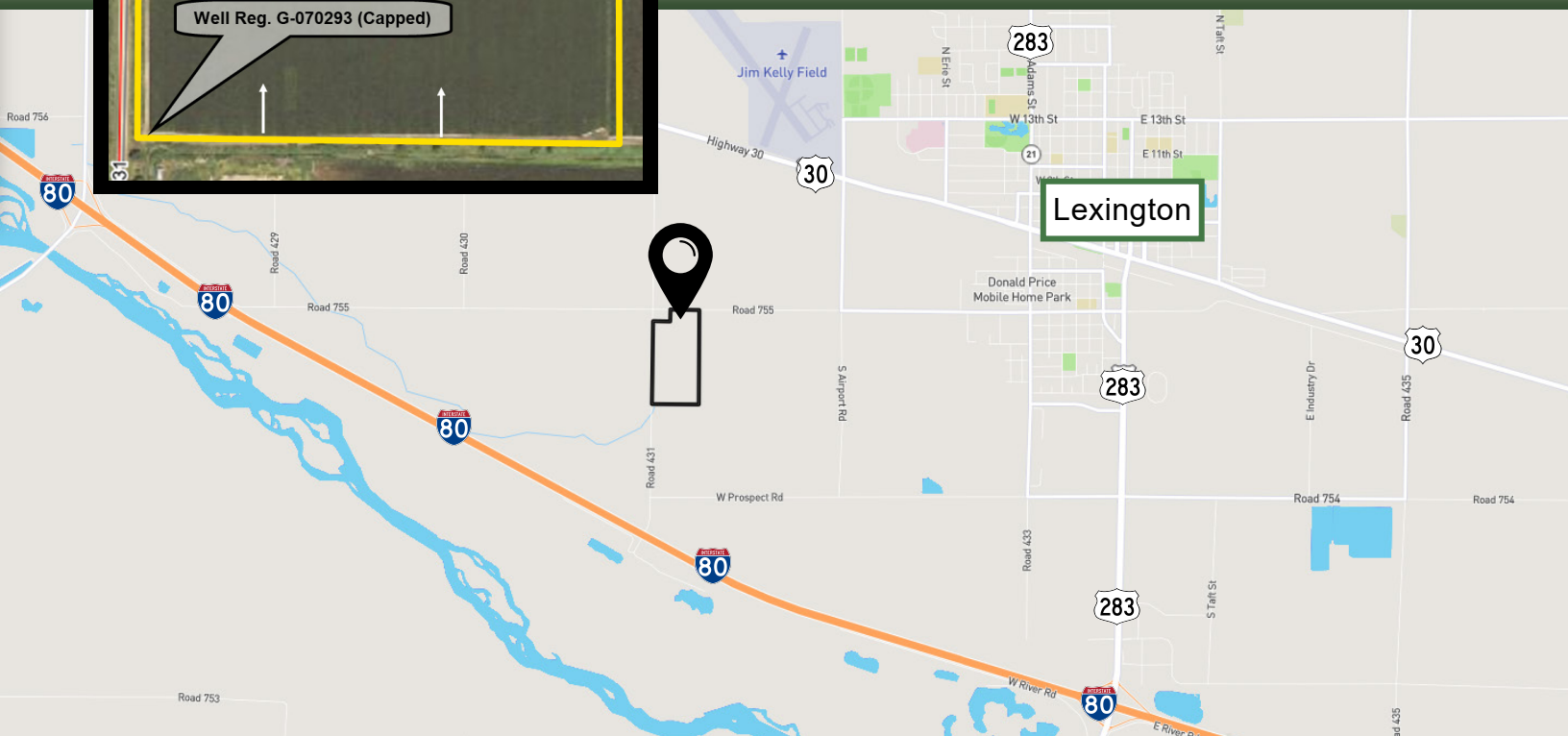



Property Information

LEGAL DESCRIPTION:	W1/2 NW1/4 Section 12, T9N-R22W of the 6th P.M., Dawson County, Nebraska, except a tract conveyed by Instrument Recorded Book 146, Page 710 of Records of Dawson County, Nebraska.				
LIST PRICE:	\$620,000				
LOCATION:	Located approximately two miles southwest of Lexington, Nebraska, with Road 755 bordering the north and Road 431 bordering the west.				
TOTAL ACRES:	76.04 tax-assessed acres				
PROPERTY DESCRIPTION:	Dawson County Assessor indicates a total of 76.04 tax-assessed acres. Davis Farm consists of gravity-irrigated cropland with an improvement site that contains a storage building.				
REAL ESTATE TAXES:	2024: \$3,283.34				
BUILDING IMPROVEMENT:	1,200 sq. ft. storage building with metal-covered roof and sides. Flooring is concrete.				
FARM SERVICE AGENCY INFORMATION:	Total cropland: 71.33 acres Government Base Acres: Corn 59.90 acres with PLC Yield of 166 bushels per acre All cropland is considered non-highly erodible by the Natural Resource Conservation Service.				
LEASE/ POSSESSION:	Full possession for the 2026 crop year.				
SOILS SUMMARY:	Soils consist primarily of Class I Gosper loam and Cozad silt loam with slopes of 0-1%, along with minor amounts of Class III Silver Creek silt loam and Gosper loam, saline-alkali, with slopes of 0-1%.				
IRRIGATION INFORMATION/ WELL DATA:	<div>Davis Farm is located in the Central Platte Natural Resources District and contains a total of 69.48 certified irrigated acres. Water for irrigation is provided by a recently-drilled electric well. The farm also contains an additional well which is capped.</div> <table><tr><td><u>Center Well</u> Well Registration: G-010746 Completion Date: 06/13/2025 @ 600 gpm Well Depth: 180' Static Water: 9' Pumping Level:85' Column: 8' Pump – Western Land Roller Power Unit – General Electric, 40hp electric motor Control Panel - Eaton</td><td><u>South Well</u> Well Registration: G-0070293 Completion Date: 005/07/1986 Well Depth: 75 Static Water: 6' Pumping Level:30' (Well is capped.)</td></tr></table>			<u>Center Well</u> Well Registration: G-010746 Completion Date: 06/13/2025 @ 600 gpm Well Depth: 180' Static Water: 9' Pumping Level:85' Column: 8' Pump – Western Land Roller Power Unit – General Electric, 40hp electric motor Control Panel - Eaton	<u>South Well</u> Well Registration: G-0070293 Completion Date: 005/07/1986 Well Depth: 75 Static Water: 6' Pumping Level:30' (Well is capped.)
<u>Center Well</u> Well Registration: G-010746 Completion Date: 06/13/2025 @ 600 gpm Well Depth: 180' Static Water: 9' Pumping Level:85' Column: 8' Pump – Western Land Roller Power Unit – General Electric, 40hp electric motor Control Panel - Eaton	<u>South Well</u> Well Registration: G-0070293 Completion Date: 005/07/1986 Well Depth: 75 Static Water: 6' Pumping Level:30' (Well is capped.)				

Property Photos

