

Soils Map

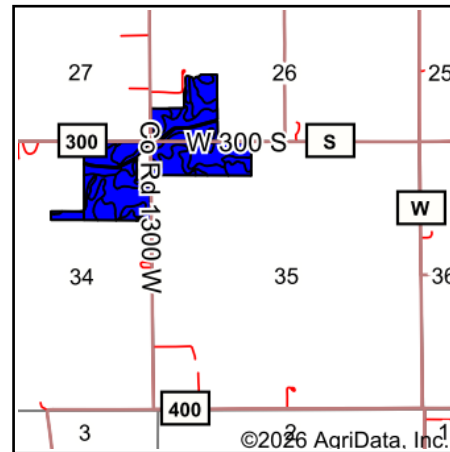

State: **Indiana**
 County: **Pulaski**
 Location: **35-30N-4W**
 Township: **White Post**
 Acres: **102.37**
 Date: **1/7/2026**

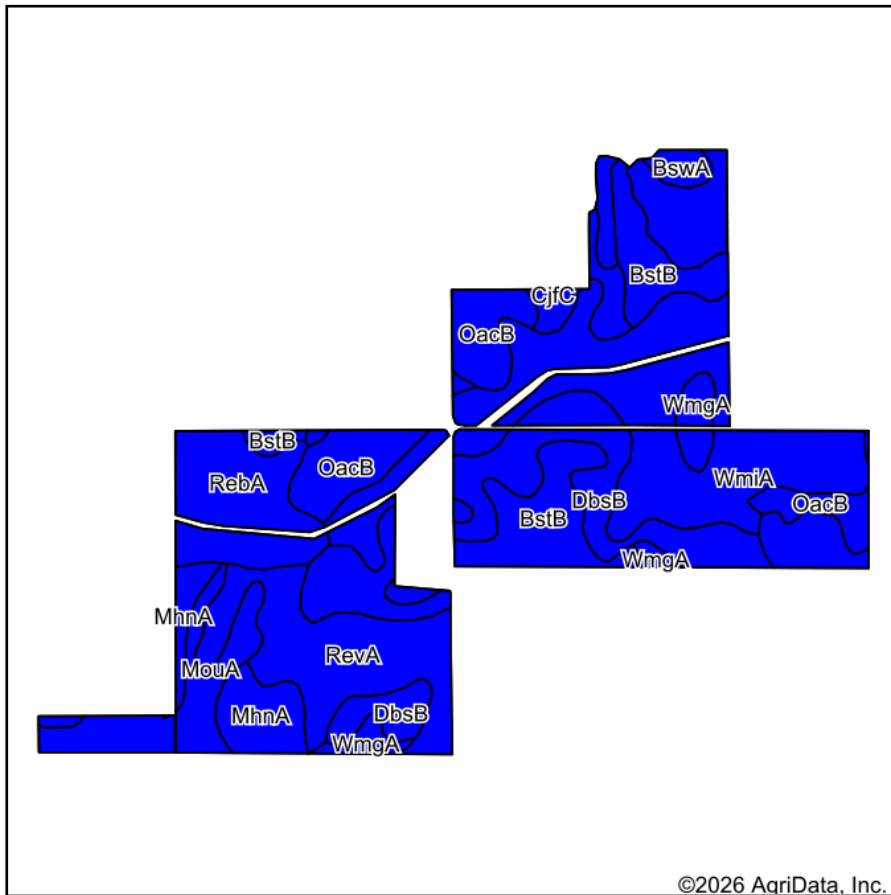

Soils data provided by USDA and NRCS.

Area Symbol: IN131, Soil Area Version: 27

Code	Soil Description	Acres	Percent of field	Non-Irr Class Legend	Non-Irr Class *c	Irr Class *c	Corn Bu	Soybeans Bu	*n NCCPI Overall
WmiA	Whitepost-Gilford fine sandy loams, 0 to 1 percent slopes	27.54	26.9%		IIw		151	34	71
DbsB	Denham fine sand, 1 to 5 percent slopes	14.83	14.5%		IVs		89	31	48
RevA	Rensselaer-Radioville loams, 0 to 1 percent slopes	14.38	14.0%		IIw		169	46	80
BstB	Brems loamy fine sand, 1 to 4 percent slopes	10.57	10.3%		IVs		97	33	52
OacB	Oakville-Denham fine sands, 1 to 5 percent slopes	8.83	8.6%		IVs		84	30	48
RebA	Radioville-Mermill loams, 0 to 1 percent slopes	8.19	8.0%		IIw		171	49	81
MouA	Milford silty clay loam, 0 to 1 percent slopes	6.12	6.0%		IIw		161	45	85
MhnA	Medaryville fine sandy loam, 0 to 1 percent slopes	4.75	4.6%		IIw		147	41	71
WmgA	Whiskerville-Bronson fine sandy loams, 0 to 1 percent slopes	2.83	2.8%		IIs	IIs	127	41	72
CjfC	Chelsea fine sand, 6 to 12 percent slopes	2.32	2.3%		VI s		82	29	51
BswA	Brems-Morocco loamy fine sands, 0 to 1 percent slopes	2.01	2.0%		IVs		98	31	52
Weighted Average					2.80	*-	131.9	37	*n 65.8

*n: The aggregation method is "Weighted Average using all components"

*c: Using Capabilities Class Dominant Condition Aggregation Method

*-: Irr Class weighted average cannot be calculated on the current soils data due to missing data.

Soils data provided by USDA and NRCS.